

## Base Unit – Maintaining the pump (new model)

### 1 Tools you will need

- Felt-tip-pen
- hexagonal key
- Small flat screwdriver
- Medium Phillips screwdriver
- 800-330007 Pump Rebuild Kit (x2)

### 2 Extracting the pump from the airpointer

- 1- Turn off and unplug the airpointer
- 2- Locate the pump at the bottom right corner of the airpointer

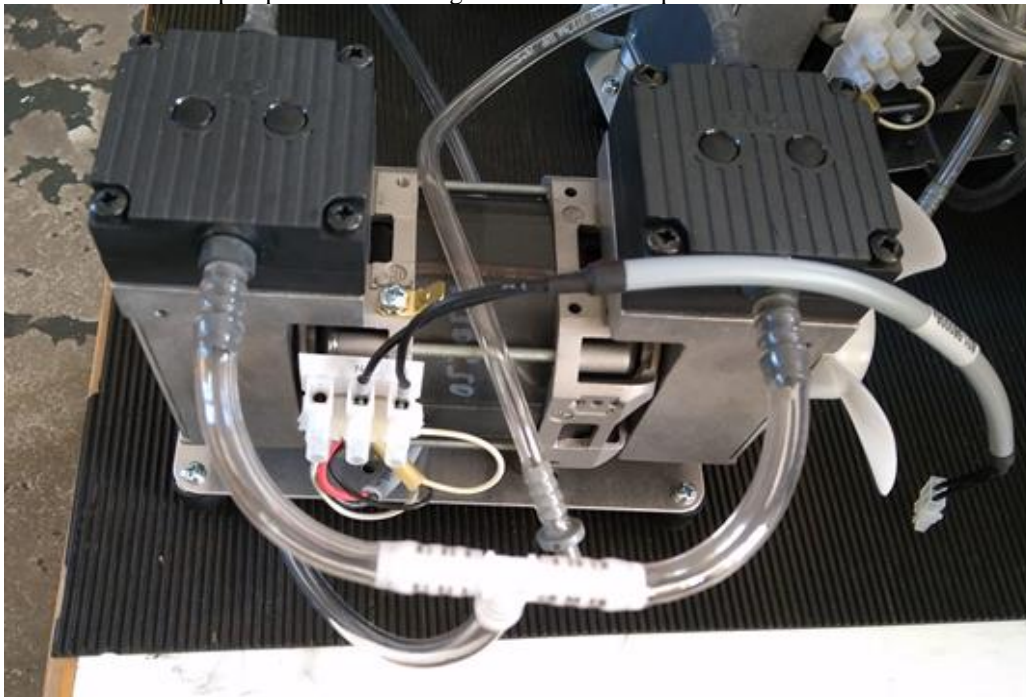

Do NOT reach inside the ventilation blades of the pump whilst the airpointer is powered on!

- 3- Remove the tubing at the inlets and exhausts of the pistons and disconnect the power cable of the pump
- 4- Unscrew the 4 feet of the pump in order to extract it from the airpointer

### 3 Maintenance of the pump

The pump has 2 pistons. Therefore, you need 2 "Pump Rebuild Kits". The procedure below describes the procedure to perform the maintenance on one piston. You must repeat the procedure for the 2<sup>nd</sup> piston

- 1- Mark the position of head and pump housing relative to each other by a drawing line with a felt-tip pen. This helps avoid incorrect assembly later

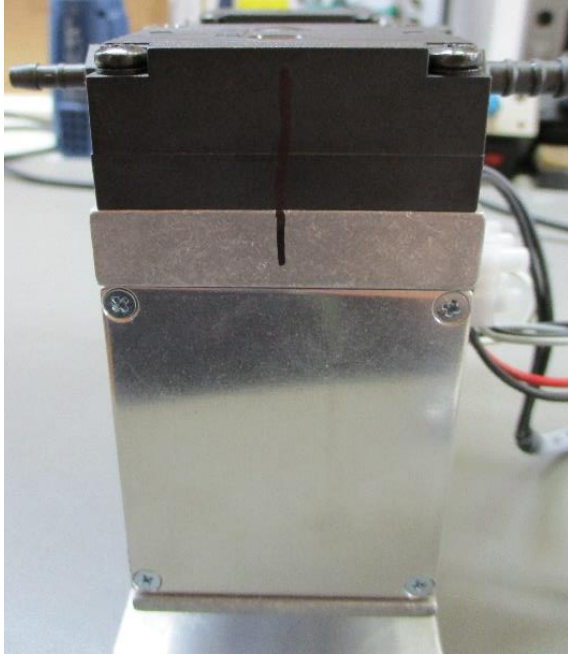

- 2- Undo the four screws in the head plate

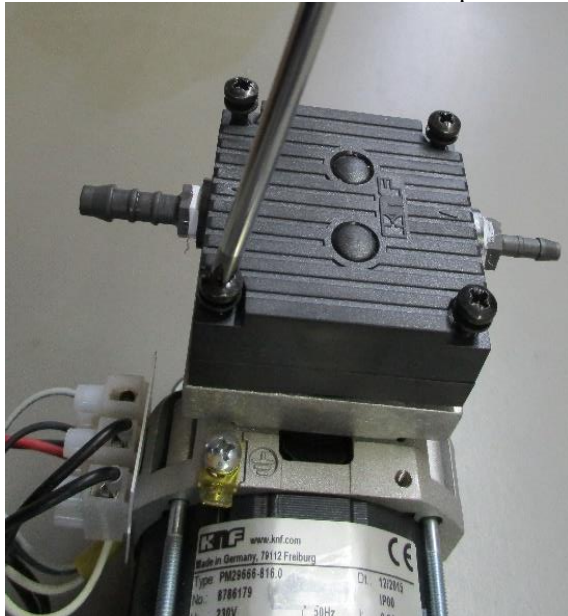

- 3- Remove the pump head from the pump housing.



- 4- Turn the fan to bring the diaphragm to top dead centre. Lift the edge of the diaphragm (12) and, gripping it on opposite sides, unscrew it by turning anti-clockwise

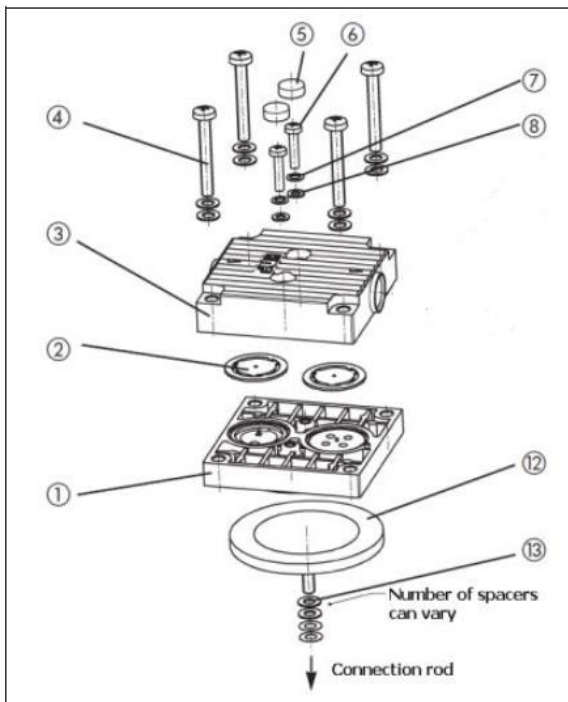

- 5- Take the diaphragm spacers (13) off the threaded portion of the diaphragm and retain them. Check that all parts are free from dirt and clean them if necessary

- 6- Put the diaphragm spacers (13) on the thread of the new diaphragm



- 7- Screw the new diaphragm (12), complete with diaphragm spacers (13), into the connection rod (clockwise) and tighten it by hand



- 8- Use a small screwdriver to remove the two screw caps (5) on the pump head and the undo the screws (6)



- 9- Separate the head plate (3) from the intermediate plate (1)

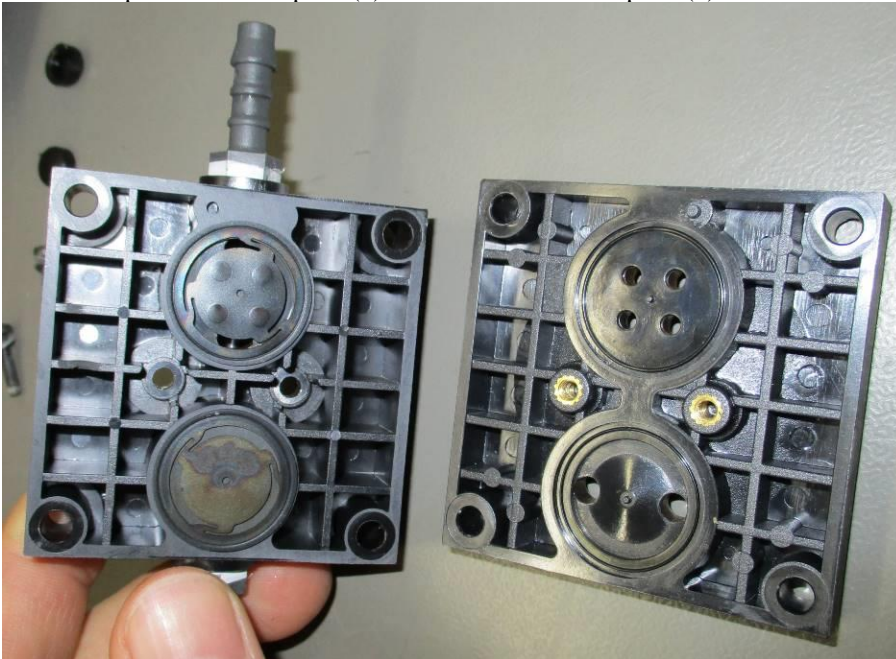

- 10- Remove the valve plates (2) from the intermediate plate (1). Check that the valve seats in the head plate and intermediate plate are clean

- 11- Lay in valve plates. The valve plates for suction and pressure sides are identical, as are upper and lower sides of the valve plates. Check that the hole on the valve plates is centred on the cantering pin of the intermediate plate (1)

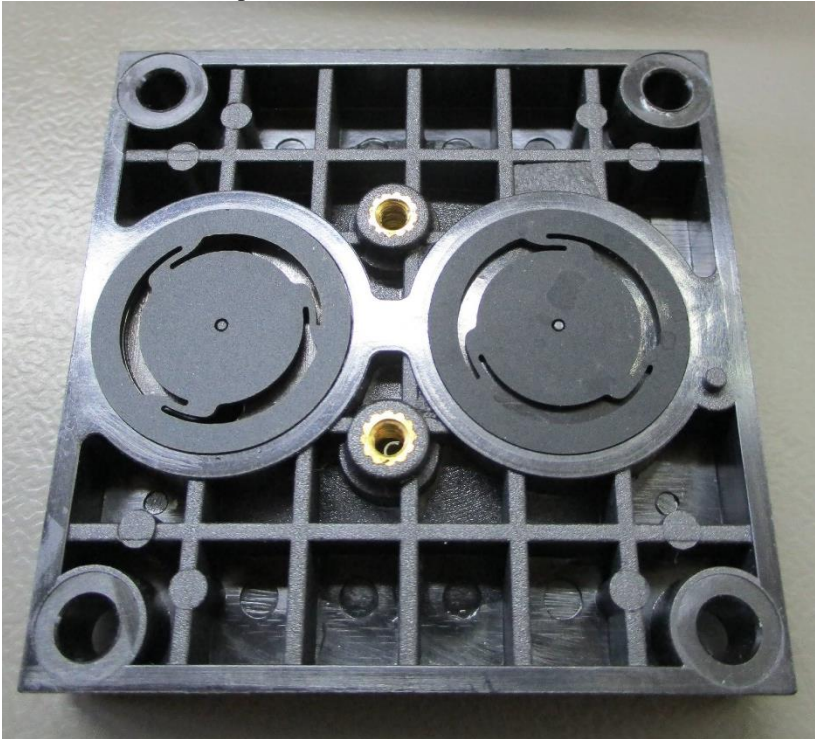

- 12- Join the head plate (3) and the intermediate plate (1) by tightening the two screws (6) hand tight

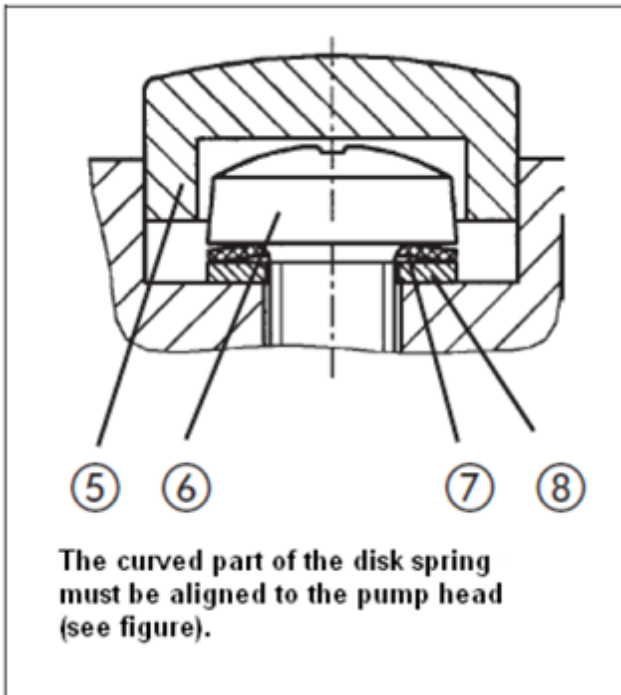

- 13- Install the screw caps. Place the pump head on the housing according to the markings. Tighten the four screws (4) diagonally. Hand – tight

- 14- Carry out the same steps for the second pump head

## 4 Change hoses

In case you want to change hoses of the pump, we provide a list of material you will need. We suggest using ¼ inch Tygon RO hose

Material you will need:

- 2 pieces of hose of approximately 10cm length, for the output connectors. Connect those to the T-piece
- 2 pieces of hose of approximately 40cm length, for the input connectors. Connect them to the grey pin wrench.

Output hoses connected to T-piece

