

Base Unit - Changing the sample filter (extended lifetime version)

The particulate filter should be inspected regularly for signs of plugging or excess dirt. If contaminated, replace the filter following the procedure outlined below. It should be replaced at regular intervals even without obvious signs of dirt. This is because filters with a pore size between 1 and 5 μm can clog while retaining a clean look. We recommend handling the filter with gloves and tweezers.

- 1- Check the pressure drop due to the sample filter in Linsens. If the pressure is above 100 mbar, it is recommended to replace the filter.

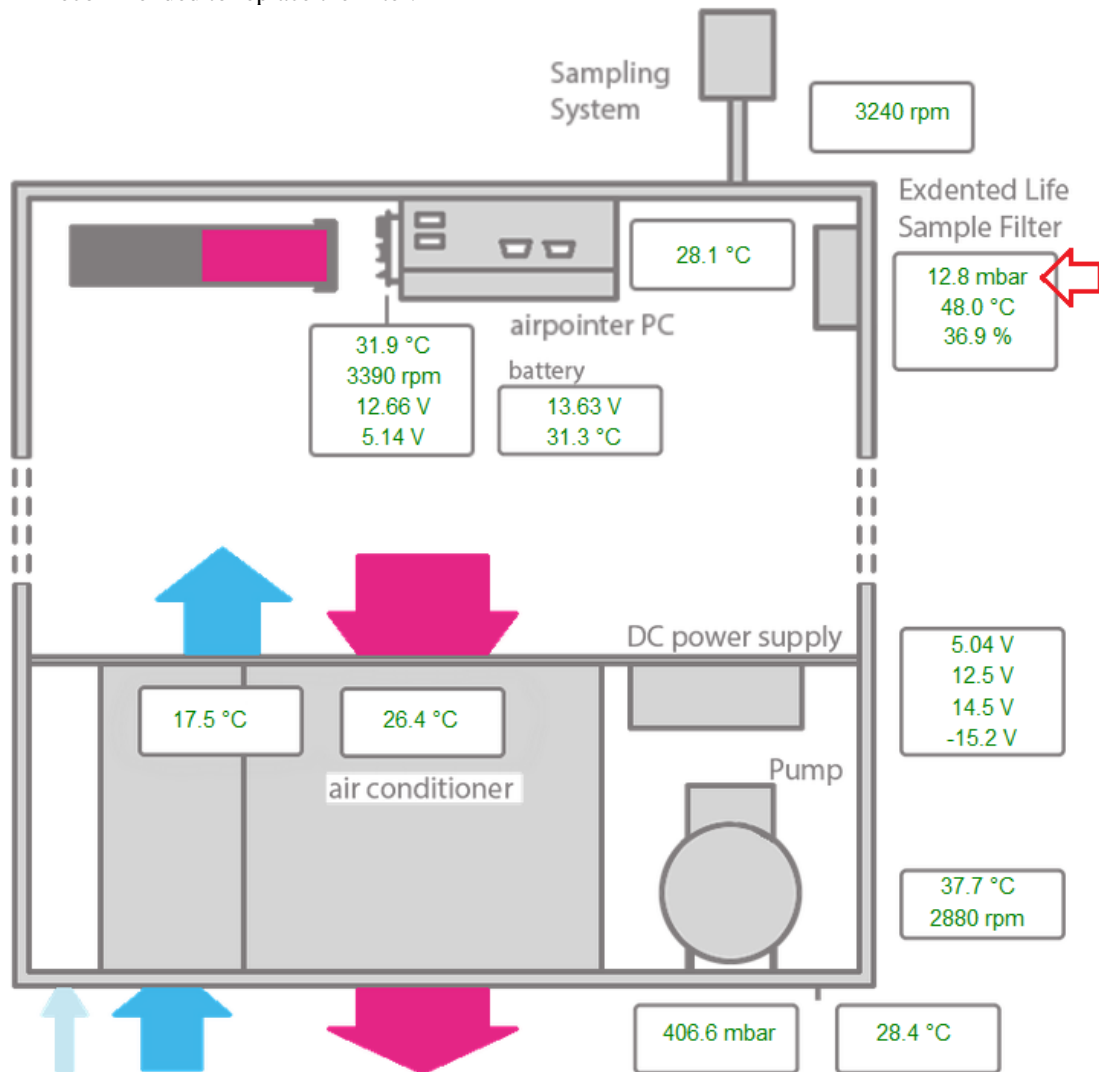

- 2- Open the maintenance door and locate the sample particulate filter

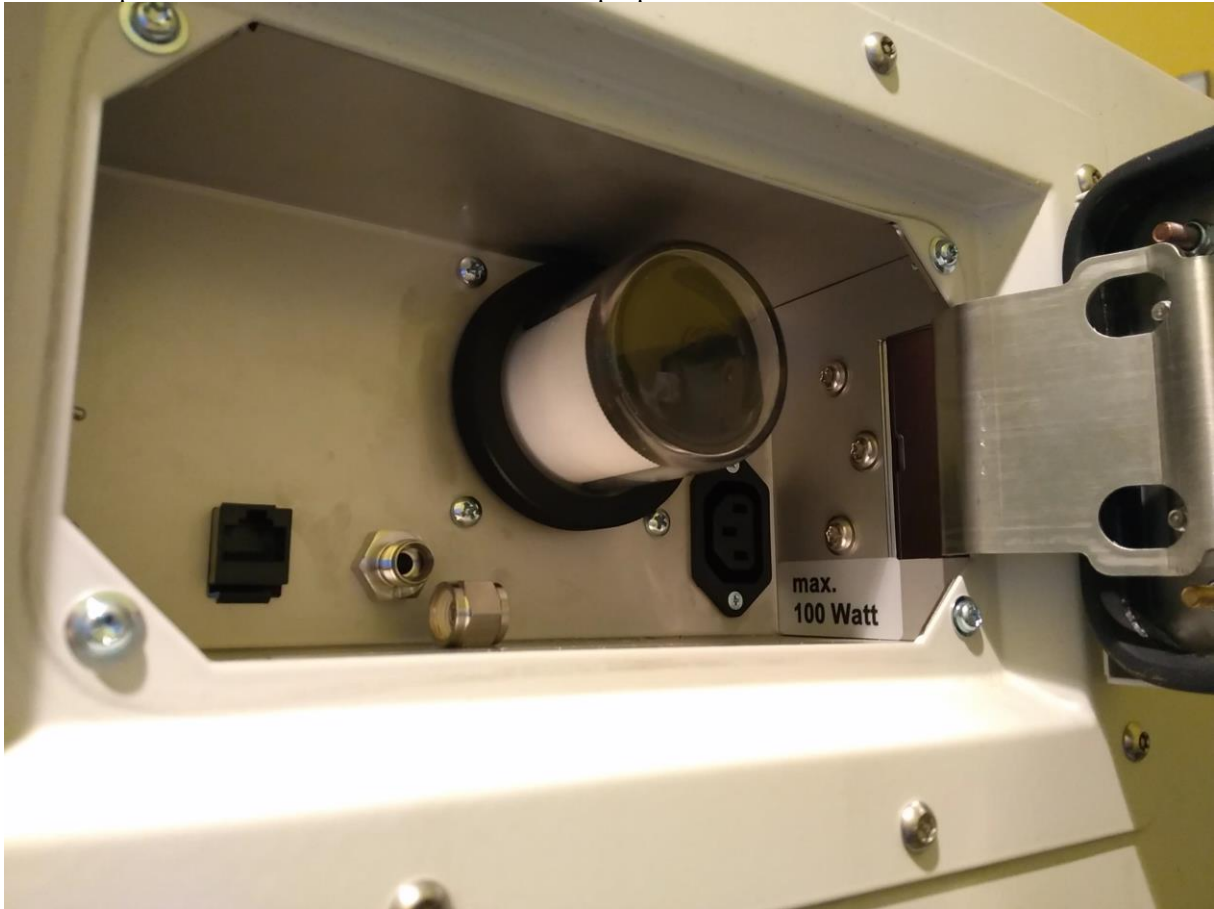

- 3- Carefully open the nut (6) with the glass window (5) which is attached by one O-Ring (12). Then remove the lid (4) by turning it anticlockwise in order to extract the sample filter (3). The Sample filter holder (1) itself stays in the airpointer. On the side of the sample filter holder (1) is an additional O-Ring (11).

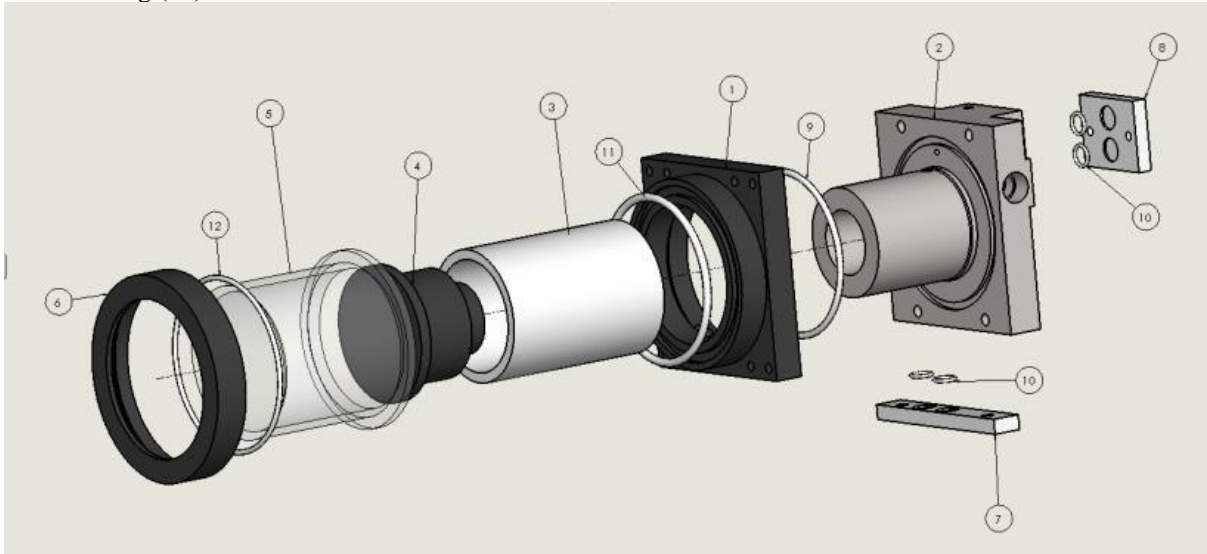

NB. If the O-Rings are porous replace them. After cleaning the O-Rings, reinstall them.

- 4- Install a new filter element, carefully centring it in the bottom of the holder, and replace the lid over it by turning it clockwise. Clean the glass window if necessary
- 5- Place the glass window, then screw on the nut, making sure that its O-Ring is in place, and hand-tighten the assembly
- 6- Perform a leak check